



for home

EPIC
J351, X725
june 2006

Kanion rainwater system

Product guide



- BROWN**
- WHITE**
- BLACK**
- BRICK RED**
- GRAPHITE**
- COPPER**

70 100 130 160

ROOF DRAINAGE SYSTEM

Top manufacturer of sanitary systems in Poland

1. Introduction

perfect GUTTER Kanion

offered colours:

BROWN
WHITE
BLACK
BRICK RED
GRAPHITE
COPPER

The Kanion rainwater system was created in co-operation with roofers and fitters, who gave it the original, elegant and stylish design. The characteristic feature of the system is its traditional yet unique profile, which changes the appearance of every building, highlighting its architectural qualities.

Kanion is intended for use in detached houses, terraced blocks, commercial premises, as well as industrial buildings, arbours, garden sheds, garages and balconies. The design of the Kanion system was based on results of marketing research conducted to determine specific user expectations. Based on our in-depth market knowledge, access to cutting-edge technologies and state-of-the-art materials, and the desire to create a perfect system, we have managed to develop a unique product.

Kanion is a rainwater system that lives up to expectations of the most demanding customers. It combines the elegant design with high water drainage efficiency. The system's hydraulic performance

and functional design ensure smooth flow of water, even during heavy storms.

Individual elements of the system are press-fitted, only external stopends are glued. As a result, no specialist tools are required to install the system; however, expert's support is recommended to ensure that the system is properly installed and leakproof. The Kanion gutters are 100% maintenance-free and characterised by high durability, tightness and efficiency of roof rainwater drainage.

Kanion is an attractive solution for the customers mainly because of its elegant design and high quality of workmanship. Individual system components are either single-packed in foil bags to prevent any mechanical damage during transport.

The Kanion gutters are 100% resistant to rainwater contaminants, which is of prime importance in seaside areas and in the aggressive industrial environment.

Gutter Flow Capacity

Effective roof area (in square metres) can be calculated using the following formula:

Effective roof area = $(B + C/2) \times$ roof length:

B – horizontal distance from the eaves to the roof ridge

C – height of roof

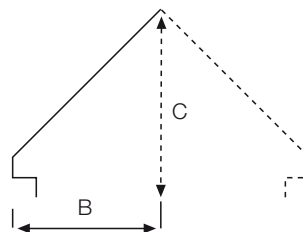

Maximum roof area to be drained by one outlet:

- gutter fall 3‰ (3 mm per 1 m of the gutter)
- rainfall intensity 75 mm/h

Maximum roof area (m²)

		Gutter 75*/ pipe 50*	Gutter 100*/ pipe 75*	Gutter 130*/ pipe 90*	Gutter 130*/ pipe 110*	Gutter 160*/ pipe 110*
	Running outlet (end)	36	66	123	140	189
	Running outlet (centre)	72	132	246	280	378
	Angle – more than 2 m from the running outlet	Roof area lessen by 5%				
	Angle - within 2 m from the running outlet	Roof area lessen by 10%				

* in millimetres (mm)

General information

Storage and transport

Pipes and gutters must be stored on a smooth surface, free of any sharp edges and surface roughness. Products must not be stacked in more than 7 layers, to ensure that elements stored at the bottom are not deformed. Fittings of various types must be stored indoors in their original packaging (foil bags) until unpacked. It is recommended that products are securely fastened while in transport. Loading and unloading of loose gutters and pipes must be manual. Special care must be taken when transporting products during winter, as low temperatures reduce the resistance of plastics to mechanical impact.

Standards and approvals

European Standard PN-EN 607
 European Standard PN-EN 12200
 European Standard PN-EN 1462
 Approval of the National Institute of Hygiene
 no. HB/B/2830/01/98
 Certificate of conformity no. ITB-0678/W

Dimensions and colours

Gutter	Downpipe	Rainwater system	A	B	C	D	E
		Kanion 70	75	55	1,6	50	1,4
		Kanion 100	100	65	1,6	75	1,8
		Kanion 130	130	88	1,6	90	2,0
		Kanion 160	160	117	1,6	110	2,2

Material	Gutters	Downpipes	Colour
PVC-u	half round, length: 2, 3 and 4 m	round, length: 2, 3 and 4 m	dark brown RAL 8017 white RAL 9010 black RAL 9017 brick red RAL 8004 graphite RAL 7016 copper RAL 8003

Basic elements of the Kanion rainwater system

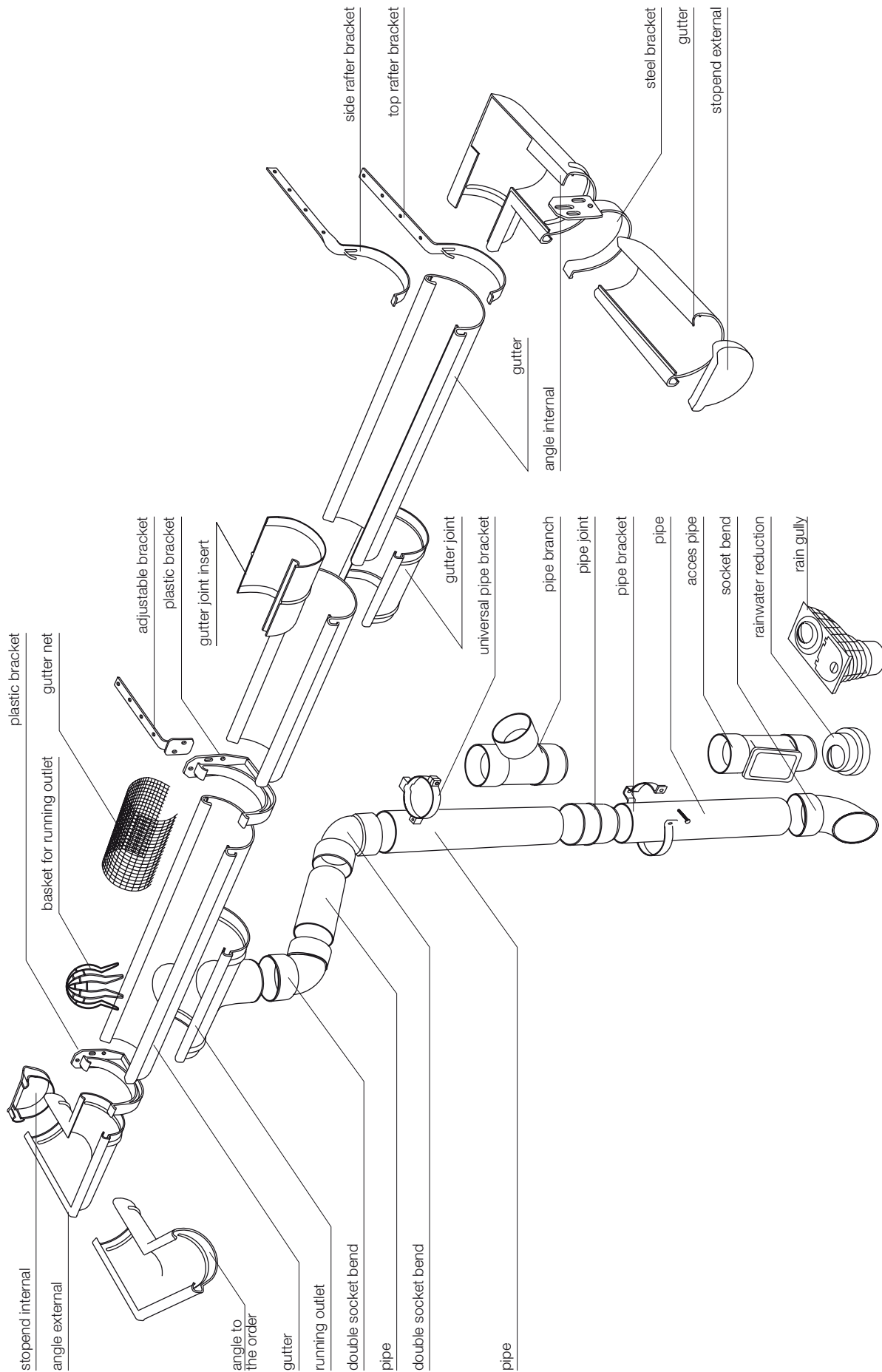

Having calculated the roof area to be drained, determine the method of installation of the gutter to the roof construction and downpipe

to the wall of the building (type of brackets), and then specify the number of individual elements required to install the system.

Gutter installation elements

The following elements can be used to install the Kanion gutter:

- top rafter or side rafter steel brackets, long and short, fixed to both rafters and battens,
- adjustable steel brackets, top rafter or side rafter, long and short, with a plastic bracket connected with two screws; the entire system is fixed to both rafters and battens,

- fascia steel brackets – fixed to the roof fascia board,
- fascia plastic brackets – also fixed to the roof fascia board.

The maximum distance for all types of gutter brackets should be 70 cm. In areas with heavy snowfall it is recommended to fasten brackets every 50 cm.

Downpipe installation elements

The following elements can be used to install downpipes in the Kanion system:

- universal steel pipe bracket with a nut; depending on the wall structure, to be used with double-side male screws with the length of 100, 160 or 220 mm (concrete walls) or a support bracket bracer (wooden or metal walls),

- plastic pipe bracket with a nut; depending on the wall structure, to be used with double-side male screws with the length of 100, 160 or 220 mm (concrete walls); alternatively, special support bracket bracer may be used to fix the bracket to wooden or metal walls.

The maximum distance between all types of gutter brackets should be 2 metres.

Basic principles of installation

To ensure proper performance of the rainwater system, the following guidelines must be followed:

1. It is important to install gutters at an appropriate height in relation to the slope of the roof. Gutters should not stick out beyond the line formed by prolonged surface of the roof; otherwise, gutters will be the only support for heaps of snow accumulating on the roof (fig. 1).
2. If it is not possible to install gutters in accordance with these guidelines, snow boards should be used. Snow boards should also be installed wherever the roof slope is facing south, and when the roof is covered with metal sheet or other slippery roofing material. In areas with heavy snowfall it is recommended to use snow boards regardless of the roof covering and direction.
3. Gutters should extend outside the ridge of the roof slope with approx. 50% of their width, so that water always flows into the gutter.

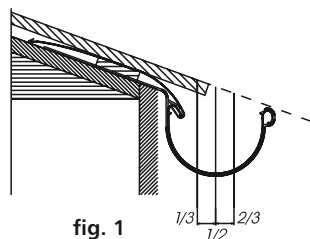

4. If the Kanion 160 system is installed in large buildings, controlled extension of gutters must be ensured. The so-called fixed points must be marked every 12 metres of the gutter. To that end, gutter brackets must be installed on both sides of the coupler to fasten it securely in place. Other brackets are installed with the required distance.
5. To make system installation as easy as possible, lubricate the seals.
6. Special care should be taken to protect installed gutters when the roof is covered with the torching membrane using a burner.
7. Rainwater system should be installed at the minimum ambient temperature of 5°C.
8. To install the system, use only the Kanion rainwater system elements with appropriate manufacturer's designations.
9. Installation guide presented in the catalogue should be followed.

Installation guide



Installation of top rafter steel brackets

1. Top rafter steel brackets should be fixed to the roof construction with the maximum distance of 70 cm. You must be very careful when bending brackets, so as not to damage their varnish coating. Between tops and bottoms of the bracket, two pieces of string must be stretched to ensure that the fall of all brackets is equal. The fall towards the running outlet should be approx. 3 mm decline along 1 m of the gutter.



Side rafter steel brackets

2. Twisted steel brackets should be fixed on one side of rafter beams.



Adjustable steel brackets

3. Adjustable steel brackets, both top rafter and side rafter, have a rectangular flat bar with two threaded mounting holes and screws. Adjustable brackets should be bent in the same way as top rafter and side rafter steel brackets, and a plastic bracket is screwed to the flat bar. The plastic bracket has two round mounting holes used to adjust the fall after the installation is complete.



Plastic fascia brackets

4. Plastic fascia brackets are fixed directly to the roof fascia board. A string is used to determine the fall; the string should be stretched between the first and the last bracket, and then the remaining brackets should be fastened (with the minimum distance of 70 cm between brackets).



Fascia steel brackets

5. Fascia steel brackets are fixed directly to the roof fascia board.



Cutting the gutter

6. The gutter should always be cut at the angle of 90° with a fine-toothed metal-cutting saw.



Installation of the gutter in plastic brackets

7. The gutter is installed by placing its front flange in the front end of the bracket, and then pressing its back flange under the back end of the bracket.



Installation of the gutter in steel brackets

8. See point 7.



Installation of the gutter union

9. The gutter union should first be placed on the front flange of connected gutters. Do not move gutters towards the centre of the coupler beyond the "gutter ends" markings. Next, snap the back end of the gutter union on the back flange of the gutter. Alternatively, the gutter union can be placed in the back flange of the gutter first and then snapped in place on the front flanges of connected gutters.

Kanion rainwater system

3. Installation guide



Installing the gutter union insert

10. To ensure fast and smooth flow of water through the gutter union, as well as higher rigidity of this section, a gutter union insert should be placed inside the gutter union. The gutter union insert should first be placed under the back flange of the gutter, and the front part of the gutter union insert should then be snapped in place under a special rib in the inner front part of the gutter.



Installing the running outlet

11. First, determine the location of the running outlet. Next, place the running outlet on the gutter and set out the opening on the gutter through the outlet port.



12. Remove the running outlet and cut the opening in the gutter with a metal-cutting saw.



Installing the angles

13. Having removed all sharp edges around the opening, place the running outlet on the gutter and fasten both elements in brackets.

14. Two types of angles are on offer: internal and external, to fit the system profile. Both types of angles are fitted with seals. To install the angle on the gutter, first remove the gutter from the nearest bracket, place the front flange of the gutter in a slot in the front part of the angle, and then securely fasten the angle on the gutter, snapping the back part of the gutter in place under the flanged profile.



External stopends

15. In the Kanion system, both external stopends are permanently glued to the gutter. Glue is delivered in a set with each stopend. The inner part of the stopend must be cleaned, covered with a layer of glue, and placed on a clean, smooth end of the gutter.



Internal stopends

16. Internal stopends are used when the running outlet or the angle is the final part of the system. The stopend is inserted into the fitting so that it touches the gasket. No glue is used to fasten these elements.

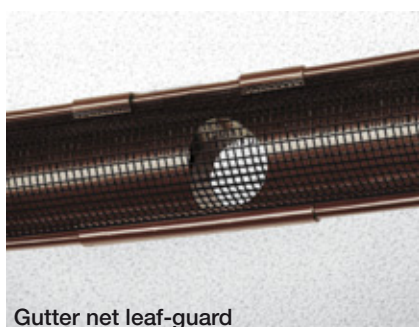

Gutter net leaf-guard

17. The diameter of the gutter net leaf-guard protecting the gutter against leaves and contamination is slightly larger than the gutter; it is therefore simply placed inside of the gutter.



Installing the downpipes using two bends

18. If the roof eaves sticks out, but the horizontal distance between the port of the running outlet and the pipe does not exceed 10 cm, the gooseneck can be made with a single-socket bend installed on the running outlet, and a double-socket bend installed on the spigot of the single-socket bend (flange downwards). Remembered that after the downpipe is inserted into the flange of a double-socket bend, the play of approx. 10 mm must be left (due to thermal expansion of pipes). The bracket must be mounted directly under the bend.

Installation guide cont.

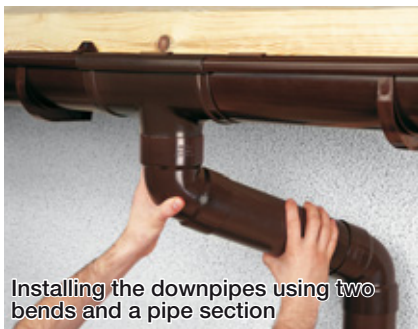

Installing the downpipes using two bends and a pipe section

19. If the distance between the eaves edge and the wall of the building exceeds 10 cm, the gooseneck must be made using a double-socket bend mounted on the port of the running outlet, flange downwards. Insert the pipe section into the flange, and another double-socket bend at the longer end. The bracket must be mounted directly under the bend.



Pipe connecting

20. Pipes are connected with pipe connectors, with flanged parts always facing downwards. Remember to leave the play of approx. 10 mm (due to thermal expansion of pipes). The bracket must be mounted directly under the coupling.

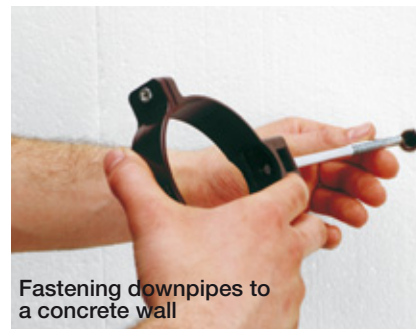

Fastening downpipes to a concrete wall

21. To install the downpipes to a concrete wall, use the universal bracket. Depending on the requirements (for instance, styrofoam cladding), double-side male screws with expansion plugs may be used (length: 100, 160 or 220 mm).

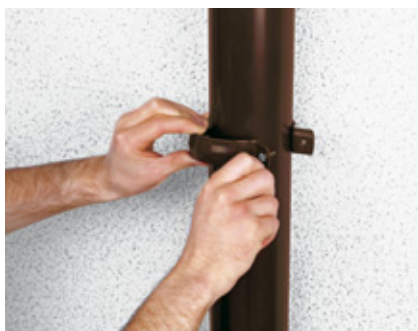

22. The maximum distance between brackets is 2 metres.



Fastening downpipes to a wooden or metal wall

23. To install the downpipe to a wooden or metal wall, use a bracket with a support bracket bracer and fix the bracket to the wall using two wood or metal screws.



Rainwater drainage

24. Rainwater can be drained off the roof to the ground with a single-socket bend installed above ground. The bend may be trimmed so that the outlet is parallel with the pipe...



25. ...or may be left as is. The bend can be glued to the pipe.



Connecting the system to the sewage system

26. If the rainwater system is to be connected to the sewage system, an access pipe must be installed in the lower section of the downpipe. The access pipe has a grate inside to collect impurities from the gutter. A tight cover is placed at the top. Before the access pipe cover (110 mm in diameter) is closed again, the seal should be lubricated. The connection between the downpipe (diameter: 75 mm and 90 mm) and the sewage piping (diameter: 110 mm) is made with a reducer.

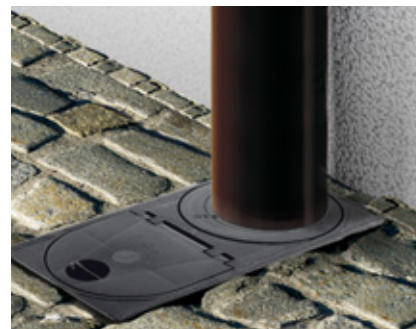

27. It is also possible to connect the rainwater system directly to the sewage system with a universal rain gully, ensuring a frost-proof, water-free odour protection; a removable basket strainer placed inside the drain collects leaves and other impurities before they enter the sewage system. Replaceable eccentric rings are used for easy connection of downpipes with the diameter of 50 mm, 75 mm, 90 mm and 110 mm.

4. Product range

Gutter

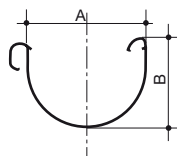

Dimensions A [mm]	Index	L [mm]	B [mm]	Colour
75	3060041724	2000	55	brown
75	3060041725	2000	55	white
75	3060041720	2000	55	black
75	3060041729	2000	55	graphite
75	3060041734	3000	55	brown
75	3060041735	3000	55	white
75	3060041730	3000	55	black
75	3060041739	3000	55	graphite
75	3060041744	4000	55	brown
75	3060041745	4000	55	white
75	3060041740	4000	55	black
75	3060041749	4000	55	graphite
100	3060042324	2000	65	brown
100	3060042325	2000	65	white
100	3060042320	2000	65	black
100	3060042329	2000	65	graphite
100	3060042334	3000	65	brown
100	3060042335	3000	65	white
100	3060042330	3000	65	black
100	3060042339	3000	65	graphite
100	3060042344	4000	65	brown
100	3060042345	4000	65	white
100	3060042340	4000	65	black
100	3060042349	4000	65	graphite
130	3060042623	2000	88	brown
130	3060042625	2000	88	white
130	3060042620	2000	88	black
130	3060043328	2000	88	brick red
130	3060042629	2000	88	graphite
130	3060042627	2000	88	copper
130	3060042633	3000	88	brown
130	3060042635	3000	88	white
130	3060042630	3000	88	black
130	3060043338	3000	88	brick red
130	3060042639	3000	88	graphite
130	3060042637	3000	88	copper
130	3060042643	4000	88	brown
130	3060042645	4000	88	white
130	3060042640	4000	88	black
130	3060043348	4000	88	brick red
130	3060042649	4000	88	graphite
130	3060042647	4000	88	copper
160	3060043424	2000	117	brown
160	3060043425	2000	117	white
160	3060043420	2000	117	black
160	3060043429	2000	117	graphite
160	3060043434	3000	117	brown
160	3060043435	3000	117	white
160	3060043430	3000	117	black
160	3060043439	3000	117	graphite
160	3060043444	4000	117	brown
160	3060043445	4000	117	white
160	3060043440	4000	117	black
160	3060043449	4000	117	graphite

Gutter Union with Insert

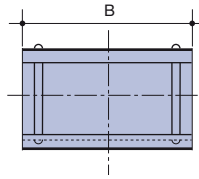

Dimensions A [mm]	Index	B [mm]	Colour
75*	3060301704	160	brown
75*	3060301705	160	white
75*	3060301700	160	black
75*	3060301707	160	graphite
100	3060302314	200	brown
100	3060302315	200	white
100	3060302310	200	black
100	3060302317	200	graphite
130	3060302614	200	brown
130	3060302615	200	white
130	3060302610	200	black
130	3060303319	200	brick red
130	3060302617	200	graphite
130	3060302618	200	copper
160	3060303414	246	brown
160	3060303415	246	white
160	3060303410	246	black
160	3060303417	246	graphite

* version with no Insert

Gutter support bracket

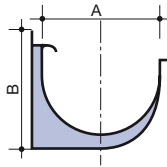

Dimensions A [mm]	Index	B [mm]	Colour
75	3060231704	85	brown
75	3060231705	85	white
75	3060231700	85	black
75	3060231707	85	graphite
100	3060232304	118	brown
100	3060232305	118	white
100	3060232300	118	black
100	3060232307	118	graphite
130	3060232604	135,5	brown
130	3060232605	135,5	white
130	3060232600	135,5	black
130	3060233309	135,5	brick red
130	3060232607	135,5	graphite
130	3060232608	135,5	copper
160	3060233404	162	brown
160	3060233405	162	white
160	3060233400	162	black
160	3060233407	162	graphite

Running outlet

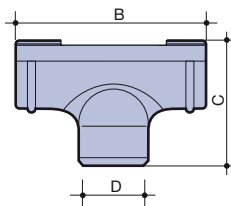

Dimensions A/D [mm]	Index	B [mm]	C [mm]	Colour
75/50	3060241704	200	107	brown
75/50	3060241705	200	107	white
75/50	3060241700	200	107	black
75/50	3060241707	200	107	graphite
100/75	3060242304	250	141	brown
100/75	3060242305	250	141	white
100/75	3060242300	250	141	black
100/75	3060242307	250	141	graphite
130/90	3060242604	250	167	brown
130/90	3060242605	250	167	white
130/90	3060242600	250	167	black
130/90	3060243309	250	167	brick red
130/90	3060242607	250	167	graphite
130/90	3060242608	250	167	copper
130/110	3060242404	310	207	brown
130/110	3060242405	310	207	white
130/110	3060242400	310	207	black
130/110	3060242407	310	207	graphite
160/110	3060243404	340	230	brown
160/110	3060243405	340	230	white
160/110	3060243400	340	230	black
160/110	3060243407	340	230	graphite

Kanion rainwater system

4. Product range

Basket for running outlet

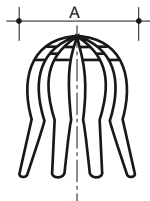
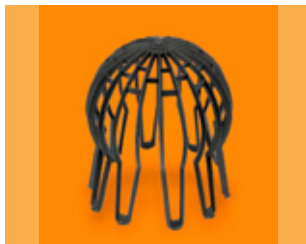

Dimensions	Index	Colour
A [mm]		
90	3160702626	black

Gutter net leaf-guard

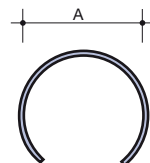
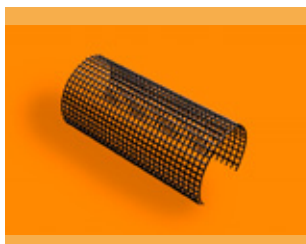

Dimensions	Index	L	Colour
A [mm]		[mm]	
75	3260701701	2000	black
100	3260702602	2000	black
130	3260702601	2000	black
160	3260703401	2000	black

External stopend

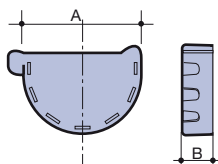

Dimensions	Index		B	Colour
A [mm]			[mm]	
75*	3060201714	left/right	25	brown
75*	3060201715	left/right	25	white
75*	3060201710	left/right	25	black
75*	3060201717	left/right	25	graphite
100	3060202394	left	20	brown
100	3060202395	left	20	white
100	3060202397	left	20	black
100	3060202390	left	20	graphite
100	3060202304	right	20	brown
100	3060202305	right	20	white
100	3060202307	right	20	black
100	3060202300	right	20	graphite
130	3060202694	left	25	brown
130	3060202695	left	25	white
130	3060202690	left	25	black
130	3060203399	left	25	brick red
130	3060202697	left	25	graphite
130	3060202698	left	25	copper
130	3060202604	right	25	brown
130	3060202605	right	25	white
130	3060202600	right	25	black
130	3060203309	right	25	brick red
130	3060202607	right	25	graphite
130	3060202608	right	25	copper
160*	3060203414	left/right	25	brown
160*	3060203415	left/right	25	white
160*	3060203410	left/right	25	black
160*	3060203417	left/right	25	graphite

* universal stopend

Internal stopend

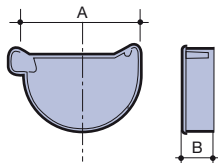

Dimensions	Index		B	Colour
A [mm]			[mm]	
75	3060201774	left	32,5	brown
75	3060201775	left	32,5	white
75	3060201770	left	32,5	black
75	3060201777	left	32,5	graphite
75	3060201764	right	32,5	brown
75	3060201765	right	32,5	white
75	3060201760	right	32,5	black
75	3060201767	right	32,5	graphite

Internal stopend cont.

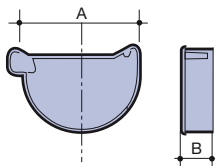

Dimensions	Index		B	Colour
A [mm]			[mm]	
100	3060202374	left	32,5	brown
100	3060202375	left	32,5	white
100	3060202377	left	32,5	black
100	3060202370	left	32,5	graphite
100	3060202364	right	32,5	brown
100	3060202365	right	32,5	white
100	3060202367	right	32,5	black
100	3060202360	right	32,5	graphite
130	3060202674	left	35	brown
130	3060202675	left	35	white
130	3060202670	left	35	black
130	3060203379	left	35	brick red
130	3060202677	left	35	graphite
130	3060202678	left	35	copper
130	3060202664	right	35	brown
130	3060202665	right	35	white
130	3060202660	right	35	black
130	3060203369	right	35	brick red
130	3060202667	right	35	graphite
130	3060202668	right	35	copper
160	3060203474	left	32,5	brown
160	3060203475	left	32,5	white
160	3060203477	left	32,5	black
160	3060203470	left	32,5	graphite
160	3060203464	right	32,5	brown
160	3060203465	right	32,5	white
160	3060203467	right	32,5	black
160	3060203460	right	32,5	graphite

External angle

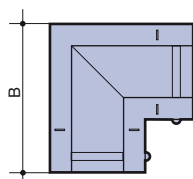

Dimensions	Index		B	Colour
A [mm]		α	[mm]	
75	3060221714	90°	160	brown
75	3060221715	90°	160	white
75	3060221710	90°	160	black
75	3060221717	90°	160	graphite
75	3060221724	135°	160	brown
75	3060221725	135°	160	white
75	3060221720	135°	160	black
75	3060221727	135°	160	graphite
75	3060221744	to order	160	brown
75	3060221745	to order	160	white
75	3060221740	to order	160	black
75	3060221747	to order	160	graphite
100	3060262324	90°	213	brown
100	3060262325	90°	213	white
100	3060262326	90°	213	black
100	3060352309	90°	213	graphite
100	3060262347	135°	213	brown
100	3060262367	135°	213	white
100	3060272317	135°	213	black
100	3060352307	135°	213	graphite
100	3060262348	to order	213	brown
100	3060262368	to order	213	white
100	3060272318	to order	213	black
100	3060352305	to order	213	graphite
130	3060262624	90°	260	brown
130	3060262625	90°	260	white
130	3060262626	90°	260	black
130	3060263329	90°	260	brick red
130	3060352609	90°	260	graphite
130	3060262621	90°	260	copper
130	3060262647	135°	260	brown
130	3060262667	135°	260	white
130	3060262617	135°	260	black
130	3060263379	135°	260	brick red
130	3060352607	135°	260	graphite
130	3060262627	135°	260	copper

Kanion rainwater system

4. Product range

External angle cont.

Dimensions A [mm]	Index	α	B [mm]	Colour
130	3060262648	to order	260	brown
130	3060262668	to order	260	white
130	3060262618	to order	260	black
130	3060263389	to order	260	brick red
130	3060352608	to order	260	graphite
130	3060262622	to order	260	copper
160	3060263424	90°	288	brown
160	3060263425	90°	288	white
160	3060263426	90°	288	black
160	3060263423	90°	288	graphite
160	3060263447	135°	288	brown
160	3060263467	135°	288	white
160	3060273417	135°	288	black
160	3060273467	135°	288	graphite
160	3060263448	to order	288	brown
160	3060263468	to order	288	white
160	3060273418	to order	288	black
160	3060273468	to order	288	graphite

Internal angle

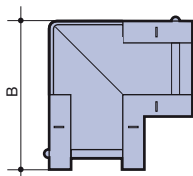

Dimensions A [mm]	Index	α	B [mm]	Colour
75	3060221734	90°	152	brown
75	3060221735	90°	152	white
75	3060221730	90°	152	black
75	3060221737	90°	152	graphite
75	3060221753	135°	152	brown
75	3060221755	135°	152	white
75	3060221750	135°	152	black
75	3060221757	135°	152	graphite
75	3060221764	to order	152	brown
75	3060221765	to order	152	white
75	3060221760	to order	152	black
75	3060221767	to order	152	graphite
100	3060262334	90°	202	brown
100	3060262335	90°	202	white
100	3060262336	90°	202	black
100	3060352319	90°	202	graphite
100	3060262357	135°	202	brown
100	3060262377	135°	202	white
100	3060272327	135°	202	black
100	3060352317	135°	202	graphite
100	3060262358	to order	202	brown
100	3060262378	to order	202	white
100	3060272328	to order	202	black
100	3060352318	to order	202	graphite
130	3060262634	90°	260	brown
130	3060262635	90°	260	white
130	3060262636	90°	260	black
130	3060263339	90°	260	brick red
130	3060352619	90°	260	graphite
130	3060262631	90°	260	copper
130	3060262657	135°	260	brown
130	3060262677	135°	260	white
130	3060262627	135°	260	black
130	3060263378	135°	260	brick red
130	3060352617	135°	260	graphite
130	3060262637	135°	260	copper
130	3060262658	to order	260	brown
130	3060262678	to order	260	white
130	3060262628	to order	260	black
130	3060263388	to order	260	brick red
130	3060352618	to order	260	graphite
130	3060262638	to order	260	copper
160	3060263434	90°	285	brown
160	3060263435	90°	285	white
160	3060263436	90°	285	black
160	3060263433	90°	285	graphite

Internal angle cont.

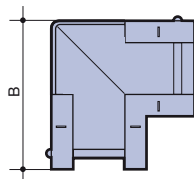

Dimensions A [mm]	Index	α	B [mm]	Colour
160	3060263457	135°	285	brown
160	3060263477	135°	285	white
160	3060273427	135°	285	black
160	3060273407	135°	285	graphite
160	3060263458	to order	285	brown
160	3060263478	to order	285	white
160	3060273428	to order	285	black
160	3060273408	to order	285	graphite

Steel fascia gutter support bracket

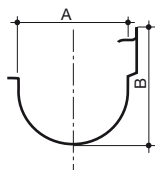

Dimensions A [mm]	Index	B [mm]	Colour
75	3186011704	162	brown
75	3186031705	162	white
75	3186131709	162	black
75	3186131700	162	graphite
100	3186012304	109	brown
100	3186012305	109	white
100	3186012309	109	black
100	3186132300	109	graphite
130	3186012604	124	brown
130	3186012605	124	white
130	3186012609	124	black
130	3186133308	124	brick red
130	3186132600	124	graphite
130	3186132607	124	copper
160	3186013404	162	brown
160	3186013405	162	white
160	3186013409	162	black
160	3186013400	162	graphite

Adjustable steel gutter support bracket

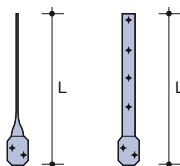

Dimensions 100 [mm]	Index		L [mm]	Colour
	3186062374	top rafter	250	brown
	3186062375	top rafter	250	white
	3186062379	top rafter	250	black
	3186062370	top rafter	250	graphite
	3186062384	side rafter	250	brown
	3186062385	side rafter	250	white
	3186062389	side rafter	250	black
	3186062380	side rafter	250	graphite

Dimensions 130 [mm]	Index		L [mm]	Colour
	3186062674	top rafter	180	brown
	3186062677	top rafter	250	brown
	3186062675	top rafter	250	white
	3186062679	top rafter	250	black
	3186042678	top rafter	250	brick red
	3186062670	top rafter	250	graphite
	3186042677	top rafter	250	copper
	3186062684	side rafter	180	brown
	3186062687	side rafter	250	brown
	3186062685	side rafter	250	white
	3186062689	side rafter	250	black
	3186042688	side rafter	250	brick red
	3186062680	side rafter	250	graphite
	3186042687	side rafter	250	copper

Steel gutter support bracket

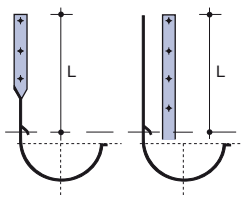
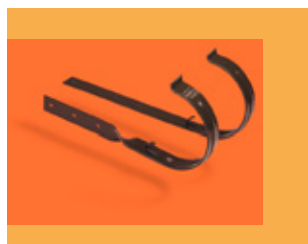

Dimensions 75 [mm]	Index		L [mm]	Colour
	3186061734	top rafter	160	brown
	3186061704	top rafter	190	brown
	3186061705	top rafter	190	white
	3186061709	top rafter	190	black
	3186061700	top rafter	190	graphite
	3186061744	side rafter	160	brown
	3186061794	side rafter	190	brown
	3186061795	side rafter	190	white
	3186061799	side rafter	190	black
	3186061790	side rafter	190	graphite

Dimensions 100 [mm]	Index		L [mm]	Colour
	3186062334	top rafter	180	brown
	3186062354	top rafter	250	brown
	3186062355	top rafter	250	white
	3186062359	top rafter	250	black
	3186062300	top rafter	250	graphite
	3186062344	side rafter	180	brown
	3186062364	side rafter	250	brown
	3186062365	side rafter	250	white
	3186062369	side rafter	250	black
	3186062390	side rafter	250	graphite

Dimensions 130 [mm]	Index		L [mm]	Colour
	3186062634	top rafter	180	brown
	3186062657	top rafter	250	brown
	3186062655	top rafter	250	white
	3186062659	top rafter	250	black
	3186042658	top rafter	250	brick red
	3186062600	top rafter	250	graphite
	3186042657	top rafter	250	copper
	3186062644	side rafter	180	brown
	3186062667	side rafter	250	brown
	3186062665	side rafter	250	white
	3186062669	side rafter	250	black
	3186042668	side rafter	250	brick red
	3186062690	side rafter	250	graphite
	3186042667	side rafter	250	copper

Dimensions 160 [mm]	Index		L [mm]	Colour
	3186063434	top rafter	180	brown
	3186043404	top rafter	250	brown
	3186043405	top rafter	250	white
	3186043409	top rafter	250	black
	3186043400	top rafter	250	graphite
	3186063443	side rafter	180	brown
	3186063494	side rafter	250	brown
	3186063495	side rafter	250	white
	3186063499	side rafter	250	black
	3186063490	side rafter	250	graphite

Downpipe

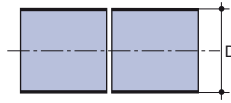
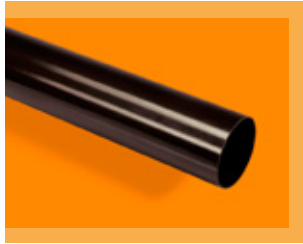

Dimensions D [mm]	Index	L [mm]	Colour
50	3060011244	2000	brown
50	3060011245	2000	white
50	3060011240	2000	black
50	3060011249	2000	graphite
50	3060011284	3000	brown
50	3060011285	3000	white
50	3060011280	3000	black
50	3060011289	3000	graphite
75	3060011843	2000	brown
75	3060012345	2000	white
75	3060012340	2000	black
75	3060011849	2000	graphite
75	3060011853	3000	brown
75	3060012355	3000	white
75	3060012350	3000	black
75	3060011859	3000	graphite
75	3060011873	4000	brown
75	3060012375	4000	white
75	3060012370	4000	black
75	3060011879	4000	graphite
90	3060012243	2000	brown
90	3060012245	2000	white
90	3060012240	2000	black
90	3060012228	2000	brick red
90	3060012249	2000	graphite
90	3060012247	2000	copper
90	3060012253	3000	brown
90	3060012255	3000	white
90	3060012250	3000	black
90	3060012288	3000	brick red
90	3060012259	3000	graphite
90	3060012257	3000	copper
90	3060012273	4000	brown
90	3060012275	4000	white
90	3060012270	4000	black
90	3060012298	4000	brick red
90	3060012279	4000	graphite
90	3060012277	4000	copper
110	3060012443	2000	brown
110	3060012445	2000	white
110	3060012440	2000	black
110	3060012449	2000	graphite
110	3060012453	3000	brown
110	3060012455	3000	white
110	3060012450	3000	black
110	3060012459	3000	graphite
110	3060012473	4000	brown
110	3060012475	4000	white
110	3060012470	4000	black
110	3060012479	4000	graphite

Single-socket bend

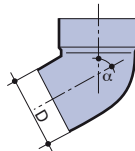
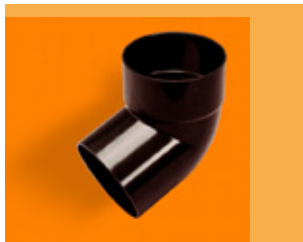

Dimensions D [mm]	Index	α	Colour
50	3060251254	67°30'	brown
50	3060251255	67°30'	white
50	3060251250	67°30'	black
50	3060251251	67°30'	graphite
75	3060251857	67°30'	brown
75	3060251855	67°30'	white
75	3060251850	67°30'	black
75	3060251853	67°30'	graphite
90	3060252254	67°30'	brown
90	3060252255	67°30'	white
90	3060252250	67°30'	black
90	3060252159	67°30'	brick red
90	3060252251	67°30'	graphite
90	3060252258	67°30'	copper

Kanion rainwater system

4. Product range

Single-socket bend cont.

Dimensions	Index	α	Colour
D [mm]			
90	3060252284	88°	brown
90	3060252285	88°	white
90	3060252280	88°	black
90	3060252189	88°	brick red
90	3060252281	88°	graphite
90	3060252288	88°	copper
110	3060252457	67°30'	brown
110	3060252455	67°30'	white
110	3060252450	67°30'	black
110	3060252451	67°30'	graphite

Pipe connector

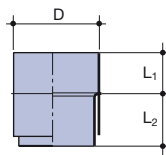

Dimensions	Index	L ₁	L ₂	Colour
D [mm]		[mm]	[mm]	
50	3060301204	34	35	brown
50	3060301205	34	35	white
50	3060301200	34	35	black
50	3060301207	34	35	graphite
75	3060301804	45	45	brown
75	3060301805	45	45	white
75	3060301800	45	45	black
75	3060301807	45	45	graphite
90	3060302204	42	42	brown
90	3060302205	42	42	white
90	3060302200	42	42	black
90	3060302109	42	42	brick red
90	3060302207	42	42	graphite
90	3060302208	42	42	copper
110	3060302404	51	51	brown
110	3060302405	51	51	white
110	3060302400	51	51	black
110	3060302407	51	51	graphite

Double-socket bend

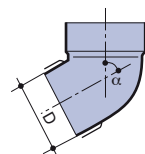
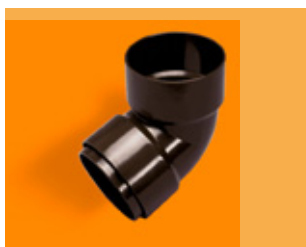

Dimensions	Index	α	Colour
D [mm]			
50	3060111254	67°30'	brown
50	3060111255	67°30'	white
50	3060111250	67°30'	black
50	3060111251	67°30'	graphite
75	3060111857	67°30'	brown
75	3060111855	67°30'	white
75	3060111850	67°30'	black
75	3060111853	67°30'	graphite
90	3060112254	67°30'	brown
90	3060112255	67°30'	white
90	3060112250	67°30'	black
90	3060112159	67°30'	brick red
90	3060112251	67°30'	graphite
90	3060112258	67°30'	copper
90	3060112284	88°	brown
90	3060112285	88°	white
90	3060112280	88°	black
90	3060112189	88°	brick red
90	3060112281	88°	graphite
90	3060112288	88°	copper
110	3060112454	67°30'	brown
110	3060112455	67°30'	white
110	3060112450	67°30'	black
110	3060112451	67°30'	graphite

Access Pipe

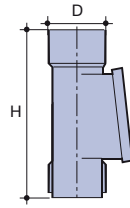

Dimensions D [mm]	Index	H [mm]	Colour
75	3060481807	235	brown
75	3060481809	235	white
75	3060481804	235	black
75	3060481802	235	graphite
90	3060482208	269	brown
90	3060482209	269	white
90	3060482204	269	black
90	3060482183	269	brick red
90	3060482202	269	graphite
90	3060482280	269	copper
110*	3060482487	303	brown
110*	3060482489	303	white
110*	3060482484	303	black
110*	3060482482	303	graphite

* version with pulled cover

Pipe Branch

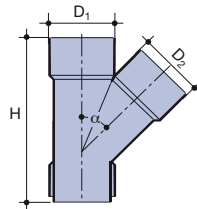

Dimensions D ₁ /D ₂ [mm]	Index	H [mm]	α	Colour
75 x 75	3060171805	183	67°30'	brown
75 x 75	3060491805	183	67°30'	white
75 x 75	3060571805	183	67°30'	black
75 x 75	3060121805	183	67°30'	graphite
90 x 75	3060172225	197	67°30'	brown
90 x 75	3060492205	197	67°30'	white
90 x 75	3060572245	197	67°30'	black
90 x 75	3060122225	197	67°30'	graphite
90 x 90	3060172205	209	67°30'	brown
90 x 90	3060492205	209	67°30'	white
90 x 90	3060572205	209	67°30'	black
90 x 90	3060512135	209	67°30'	brick red
90 x 90	3060122205	209	67°30'	graphite
90 x 90	3060512235	209	67°30'	copper
110 x 110	3060182405	241	67°30'	brown
110 x 110	3060492405	241	67°30'	white
110 x 110	3060572405	241	67°30'	black
110 x 110	3060652405	241	67°30'	graphite

Reducer

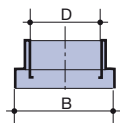

Dimensions D [mm]	Index	B [mm]	Colour
50	3060472474	110**	brown
50	3060472475	110**	white
50	3060472470	110**	black
50	3060472477	110**	graphite
50	3060471834	75**	brown
50	3060471835	75**	white
50	3060471830	75**	black
50	3060471837	75**	graphite
75	3060471823	110	brown
75	3060471845	110	white
75	3060471840	110	black
75	3060471827	110	graphite
90	3060472223	110	brown
90	3060472225	110	white
90	3060472220	110	black
90	3060472129	110	brick red
90	3060472227	110	graphite
90	3060472228	110	copper

Kanion rainwater system

4. Product range

Reducer cont.

Dimensions D [mm]	Index	B [mm]	Colour
75	3060472444	110**	brown
75	3060472445	110**	white
75	3060472440	110**	black
75	3060472447	110**	graphite
90	3060472424	110**	brown
90	3060472425	110**	white
90	3060472420	110**	black
90	3060472427	110**	graphite

** with a socket

Universal steel pipe bracket

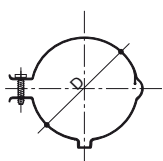

Dimensions D [mm]	Index	Colour
50	3186411204	brown
50	3186411205	white
50	3186411209	black
50	3186411200	graphite
75	3186412304	brown
75	3196412305	white
75	3186412309	black
75	3186411800	graphite
90	3186412204	brown
90	3196412205	white
90	3186412209	black
90	3186412208	brick red
90	3186412200	graphite
90	3186412207	copper
110	3186042403	brown
110	3186042405	white
110	3186042409	black
110	3186412400	graphite

Pipe bracket

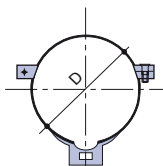

Dimensions D [mm]	Index	Colour
75	3060751840	brown
75	3060751850	white
75	3060751800	black
75	3060751870	graphite
90	3060752240	brown
90	3060752250	white
90	3060752200	black
90	3060232108	brick red
90	3060752270	graphite
90	3060232208	copper
110	3060752440	brown
110	3060752450	white
110	3060752400	black
110	3060752470	graphite

M8 Double-side male screw

with expansion plug

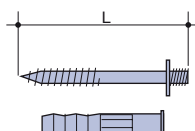

Index	L [mm]
3186510020	100
3186510010	160
3186510030	220

Steel support bracket bracer

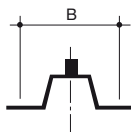

Index	B [mm]	Colour
3186522204	60	brown
3186522205	60	white
3186522209	60	black
3186523308	60	brick red
3186522600	60	graphite
3186522607	60	copper

Universal rain gully

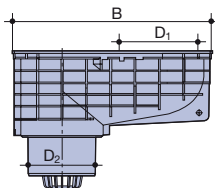

Dimensions B [mm]	Index	D ₁ [mm]	D ₂ [mm]	Colour
327	3160000660	50/75/90/110	110	black

Straight steel gutter support bracket

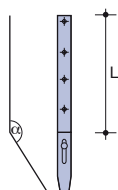

Index	L [mm]	α	Colour
180 3186062377	180	45°	ocynk.

Bracket bender

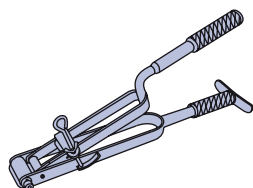

Index	Colour
3186533001	ocynk.

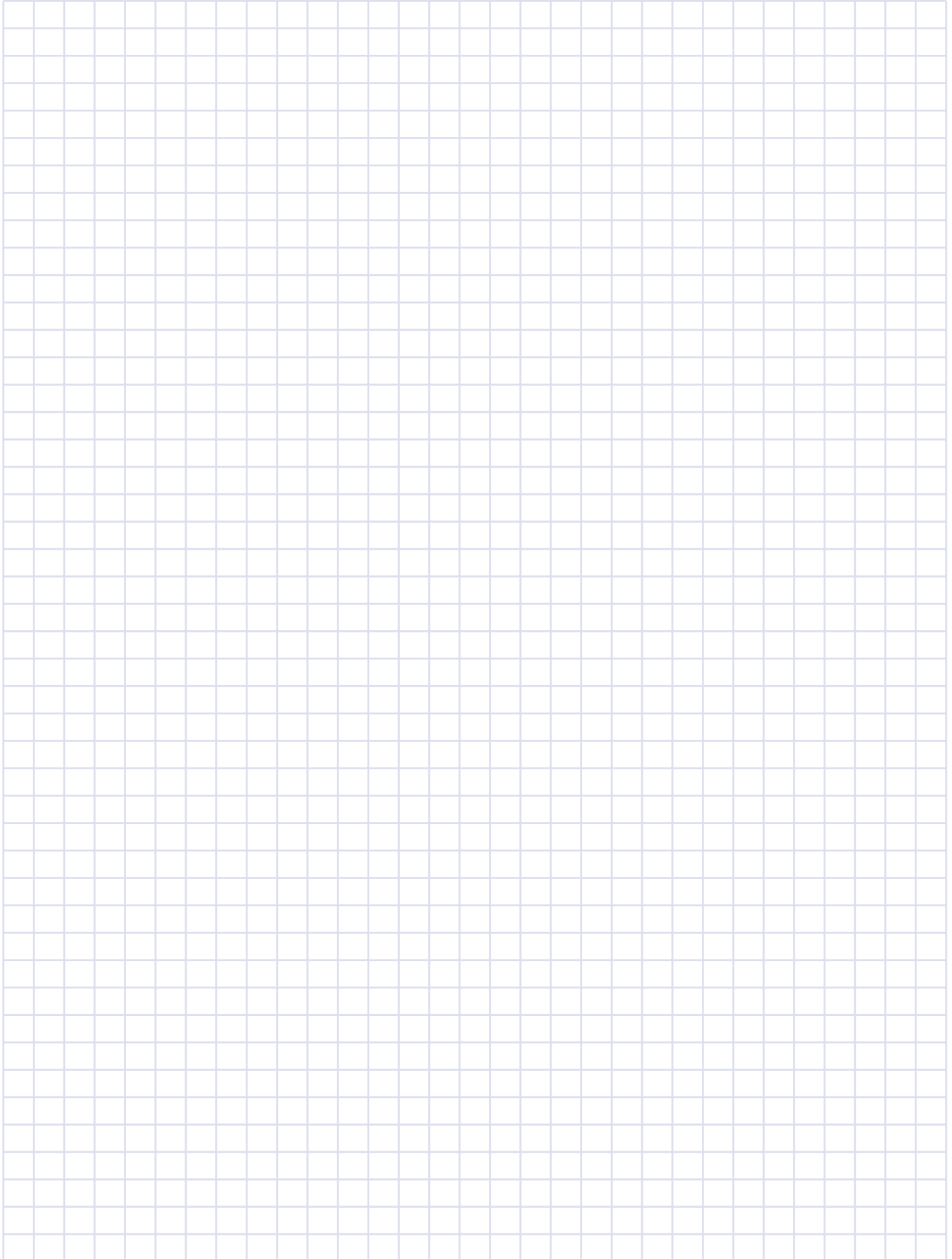



An ordinary gutter or...

perfect GUTTER Kanion

The Kanion rainwater system was co-developed by roofers; as a result, it is the only system available on the market including a wide range of unique solutions to make its day-to-day operation easier.

external flange

stiffens the profile, prevents deformations during use, and makes the appearance more attractive

internal flange

prevents water splash over the facade of the building

gutter support bracket fastening

adjustment of the gutter flange profile and the bracket profile guarantees a robust and reliable connection

external flange of the fitting

adjustment of the fitting profile and the gutter profile guarantees a secure and permanent fastening of both elements

gutter union insert

prevents accumulation of impurities and ensures self-cleaning of the entire system

gutter ribbed seals

ribbed seals made of EPDM ensure tightness of the entire system, and their location keeps them securely in place when the gutter is moving

**10 YEARS
GUARANTEE**



WAVIN

for home

wavin

for home

Kanion rainwater system

Product guide



“WAVIN for home” sanitary and heating installation system

Our goal is to provide our individual and institutional investors with top-quality building installation and heating systems. Based on many years of experience, access to cutting-edge technologies, innovative solutions, and focus on customer needs, we are able to offer the following range of reliable products:

- PVC soil & waste system and Wavin AS low-noise sanitary system,
- sanitary and heating installation systems: Tigris Alupex, Tigris Pex, BORplus, Hepworth,
- Wavin QuickStream syphonic roof drainage system,
- Kanion gutter systems,
- around the house drainage,
- linear drainage system,
- individual sewer treatment system.

All Wavin products come with complete catalogue documentation and support of our technical experts.



Wavin Metalplast-Buk is continuously developing and improving its products; therefore, we reserve the right to modify or change our product specifications without prior notice. All information contained herein was prepared in good faith and was considered up-to-date and without any reservations as at the date when this specification was printed. This catalogue does not constitute an offer within the meaning of the Civil Code, only information on the product portfolio offered by Wavin Metalplast-Buk.

wavin

Wavin Metalplast-Buk Sp. z o.o.

Dobieżynska 43
64-320 Buk

phone: +48 (61) 891 10 00

fax: +48 (61) 891 10 11

e-mail: kontakt_pl@wavin.pl

www. wavin.pl